

GUIDANCE ON DRAWING REQUIREMENTS

Existing and Proposed Elevations (at a scale of 1:50 or 1:100)

These should show full elevations of the proposal from all aspects. Existing elevations should be shown separately. This should include the proposed building materials and the style, materials and finish of windows and doors. Blank elevations must also be included, if only to show that this is in fact the case.

Where a proposed elevation adjoins another building or is in close proximity, the drawings should clearly show the relationship between the buildings and detail the positions of the openings on each property. The level of the ground floor and of the site should be shown in relation to the level of the adjoining street.



Existing and Proposed Floor Plans (at a scale of 1:50 or 1:100)

These should explain the proposal in detail. Where existing buildings or walls are to be demolished, these should be clearly shown. The drawings submitted should show details of the existing building(s) as well as those for the proposed development. New buildings should also be shown in context with adjacent buildings (including property numbers where applicable).

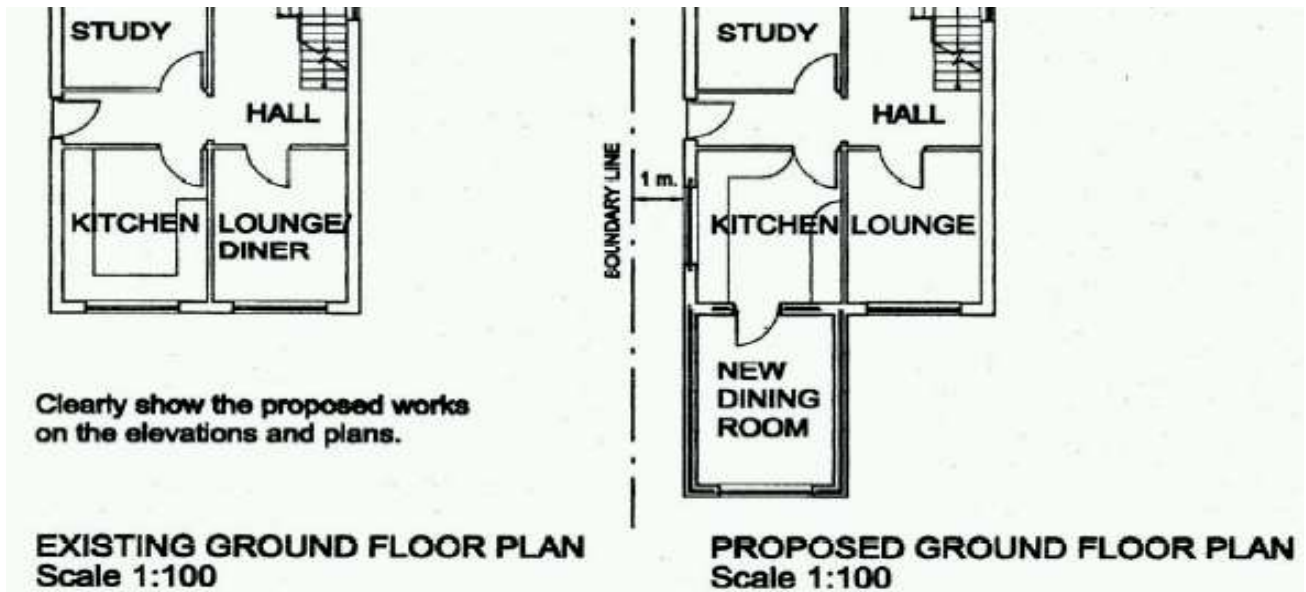

Photographs

These provide useful background information and can help to show how large developments can be satisfactorily integrated within the street scene. Photographs should be provided if the proposal involves the demolition of an existing building or development affecting a Conservation Area or a listed building.

The Photographs should be up to date, dated and labelled with the site address and the viewpoint from which they were taken.