

Application for a minor variation to a premises licence or club premises certificate under the Licensing Act 2003

PLEASE READ THE FOLLOWING INSTRUCTIONS FIRST

Before completing this form please read the Guidance Notes at the end of the form, especially Note 1.

If you are completing this form by hand please write legibly in block capitals. In all cases ensure that your answers are inside the boxes and in black ink. Use additional sheets if necessary. Once completed please send your application to the relevant licensing authority. You may wish to keep a copy of the completed form for your records.

Longbow Bars and Restaurants Limited

(Insert name(s) of applicant)

being the premises licence holder(s) / club holding a club premises certificate, apply to vary a premises licence under section 41A / club premises certificate under section 86A of the Licensing Act 2003 for the premises described in Part 1 below.

Part 1 – Premises details

Postal address of premises (or, if none, ordnance survey map reference, or description) George Hotel , Main Road, Hathersage	
Post town Hope Valley	Post Code S32 1BB

Telephone number at premises (if any)

Premises licence number/club premises certificate number

Brief description of premises (Please see Guidance Note 2)

Premises is licensed to provide sale by retail of alcohol both on and off the premises, together with regulated entertainment as detailed in the Premises Licence.

Part 2 – Applicant Details

I am/ we are the premises licence holder/club premises certificate holder
(please delete as appropriate)

Please tick ✓yes

Contact phone number in working hours (if any)

c/o John Gaunt & Partners
0114 2668664

Applicant Postal address IF DIFFERENT FROM PREMISES ADDRESS

Longbow Bars and Restaurants Limited, The Maynard, Main Road

Post town
Grindleford

Postcode
S32 2HE

Please provide email address if you would prefer us to contact you by email (optional)

Part 3 – Proposed variation(s)

Do you want the proposed variation to have effect as soon as possible?
On completion of the works.

Please tick ✓yes ✓no

If not, from what date do you want the variation to take effect?

DD MM YYYY

Do you want the proposed variation to have effect in relation to the introduction of the late night levy? (Please see Guidance Note 3)

✓yes ✓no

Please describe the proposed variation(s) in detail in the box below and explain why you consider that they could not have an adverse effect on the promotion of any of the licensing objectives (See Guidance Note 1). This should include whether new or increased levels of licensable activities will be taking place indoors or outdoors (indoors may include a tent):

Details of proposed variations (Please see Guidance Note 4)

The proposed variation is to approve layout changes to the ground floor of the premises as detailed on the plan deposited with the Licensing Authority, drawing number 4558-07-01 Revision C, which principally can be summarised as follows:

- knocking through the reception area into the Courtyard Suite function room but turning that into an expanded dining area as particularised on the deposited plan;
- including pizza oven/station in that area as particularised;
- adding universal access toilet in the reception area as particularised;
- relocating bar servery as particularised; and
- changes to fixed seating throughout as particularised.

The minor variation only affects the area shown on the plans. All other areas of the premises currently licensed which are not included on the plan deposited with this application shall remain licensed as existing.

Due to the minor nature of the changes, it is not considered that the refurbishment works will adversely affect the four licensing objectives.

In that no change is proposed to the licensable activities / hours or conditions on this Licence, Boxes A – H, late night refreshment and sale by retail of alcohol have not been ticked.

Part 4 – Operating Schedule

Please tick those parts of the Operating Schedule which would be subject to change if this application to vary were successful.

Provision of regulated entertainment (please read guidance note 5)

- Please tick ✓ yes*
- a. plays
 - b. films
 - c. indoor sporting events
 - d. boxing or wrestling entertainment
 - e. live music
 - f. recorded music
 - g. performances of dance
 - h. anything of a similar description to that falling within (e), (f) or (g)

Provision of late night refreshment

Sale by retail of alcohol

(Note that this can only relate to reducing licensed hours, or moving them without any overall increase between 7am and 11pm)

Please tick to indicate you have enclosed the following:

I have enclosed the premises licence/club premises certificate

I have enclosed the relevant part of the premises licence/ club premises certificate.

I have included a copy of the plan
(this is necessary if the proposed variation will affect the layout)

If you have not ticked one of the previous three boxes, please explain why in the box below.

Reasons why you have failed to enclose the premises licence/club premises certificate or relevant parts.

The premises licence is with the licensing authority following a premises licence transfer application submitted in June 2021.

Any further information to support your application. (See Guidance Note 6)
The proposed refurbishment works are intended to improve the premises.

CHECKLIST:

Please tick to indicate agreement

- Please tick ✓ yes*
- I have made or enclosed payment of the fee
 - I have not made or enclosed payment of the fee because this application has been made in relation to the introduction of the late night levy
 - I have enclosed the plan, if appropriate, of the premises in scale 1mm to 100mm, unless otherwise agreed with the licensing authority
 - I have enclosed the premises licence/club premises certificate or relevant part of it or provided an explanation
 - I understand that if I do not comply with the above requirements my application will be rejected.

I understand that I must now advertise my application for a continuous period beginning on the first working day after the day on which the application was given to the relevant licensing authority and ending at the expiry of the ninth consecutive working day after that day.

IT IS AN OFFENCE, LIABLE ON CONVICTION TO A FINE UP TO LEVEL 5 ON THE STANDARD SCALE UNDER SECTION 158 OF THE LICENSING ACT 2003 TO MAKE A FALSE STATEMENT IN OR IN CONNECTION WITH THIS APPLICATION.

Part 5 – Signatures and Contact Details

(See Guidance Note 7)

Premises Licence: Signature of applicant (the current premises licence holder) or applicant's solicitor or other duly authorised agent. (See Guidance Note 8) If signing on behalf of the applicant, please state your name and in what capacity you are authorised to sign:

Signature: John Gaunt & Partners

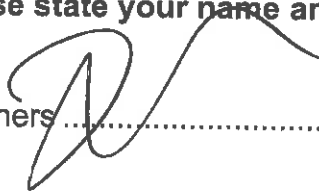

Date: 26th August 2021

Capacity: Solicitors for the Applicant

Where the premises licence is jointly held, signature of 2nd applicant (the current premises licence holder) or 2nd applicant's solicitor or other authorised agent (See Guidance Note 9). If signing on behalf of the applicant please state in what capacity.

Signature:

Date:

Capacity:.....

Where the premises is a club

I (*insert full name*) make this application on behalf of the club and have authority to bind the club

Signature:

Date:

Capacity:.....

Contact name (where not previously given) and address for correspondence associated with this application. (See Guidance Note 10)

**John Gaunt & Partners
Omega Court
372 Cemetery Road**

Post town Sheffield

Post code S11 8FT

Telephone number (if any)

If you would prefer us to correspond with you by email your email address (optional)

0114 266 8664

probson@john-gaunt.co.uk

Notes for Guidance

1. **General Note:** The minor variations process can only be used for variations that could have no adverse impact on the promotion of any of the four licensing objectives. (These are: the prevention of crime and disorder; public safety; the prevention of public nuisance; and the protection of children from harm.)

It cannot be used to:

- extend the period for which the licence has effect;
- vary substantially the premises to which it relates;
- specify, in a premises licence, an individual as the designated premises supervisor;
- add the sale by retail or supply of alcohol as an activity authorised by a licence or certificate;
- authorise the sale by retail or supply of alcohol at any time between 11pm and 7am;
- authorise an increase in the amount of time on any day during which alcohol may be sold by retail or supplied;
- include the alternative licence condition referred to in section 41D(3) of the Licensing Act 2003 in a premises licence.

2. **Description of premises:** For example the type of premises, its general situation and layout and any other information which could be relevant to the licensing objectives. This should include any activities in or associated with the use of the premises which may give rise to concern in respect of children regardless of whether you intend children to have access to the premises, for example (but not exclusively) nudity or semi-nudity, films for restricted age groups, the presence of gaming machines etc.

3. You do not have to pay a fee if the only purpose of the variation for which you are applying is to avoid becoming liable to the late night levy.

4. **Give full details of all the proposed variation(s).** Failure to provide sufficient information may lead to the refusal of your application. Details should include a description of the proposed variation(s) in terms as precise as possible. If you are not precise, the licensing authority may decide that the changes you propose would be potentially broader in scope than you intend and reject your application as not being a 'minor' variation. You should also include a statement about why you consider the variations proposed could not have an impact on the licensing objectives listed in section 4(2) of the Act. You should cover each of the objectives that could possibly apply to your proposal (or if more than one, to each proposal) and say why you think there could be no adverse impact on that objective. Your application will be assisted by including as much information as you can

about this. (However, there is a box at the end of the form for 'further information', and this should be used for any relevant background information not directly related to the variation.) Relevant information includes:

a) **Variations to licensable activities/licensing hours** (all timings should be given in 24 hour clock e.g. 16.00. Only give details for the days of the week when you intend the premises to be used for the activity), such as:

- Whether new or increased levels of licensable activities will be taking place indoors or outdoors (indoors may include a tent);
- Relevant further details, for example whether music will be amplified or unamplified;
- Standard days and timing when the activity will take place, including start and finish times;
- Any seasonal variations in timings, e.g. additional days during the summer; and
- Non-standard timings, e.g. where you wish the activity to go on longer on a particular day such as Christmas Eve.

b) **Variations to premises/club layout:** If you are applying for a variation to the layout of your premises, you must include a revised plan. You should be aware that your application is likely to be refused if the proposed variation could:

- increase capacity for drinking on the premises;
- affect access between the public part of the premises and the rest of the premises or the street or public way, e.g. block emergency exits or routes to emergency exits; or
- impede the effective operation of a noise reduction measure.

c) **Revisions, removals and additions of conditions:** The minor variation process may be used to remove conditions which are out of date or invalid and to revise conditions which are unclear (as long as the intention and effect remains the same). It can also be used to add a new condition volunteered by the applicant or mutually agreed between the applicant and a responsible authority, such as the police or the environmental health authority (subject to impact on the licensing objectives).

d) **Variations to opening hours:** details of any changes to hours when the premises or club is open to the public.

5. In terms of specific regulated entertainments please note that:

- Plays: no licence is required for performances between 08.00 and 23.00 on any day, provided that the audience does not exceed 500.
- Films: no licence is required for 'not-for-profit' film exhibition held in community premises between 08.00 and 23.00 on any day provided that the audience does not exceed 500 and the organiser (a) gets consent to the screening from a person who is responsible for the premises; and (b) ensures that each such screening abides by age classification ratings.
- Indoor sporting events: no licence is required for performances between 08.00 and 23.00 on any day, provided that the audience does not exceed 1000.
- Boxing or Wrestling Entertainment: no licence is required for a contest, exhibition or display of Greco-Roman wrestling, or freestyle wrestling between 08.00 and 23.00 on any day, provided that the audience does not exceed 1000. Combined fighting sports – defined as a contest, exhibition or display which combines boxing or wrestling with one or more martial arts – are licensable as a boxing or wrestling entertainment rather than an indoor sporting event.
- Live music: no licence permission is required for:
 - a performance of unamplified live music between 08.00 and 23.00 on any day, on any premises.
 - a performance of amplified live music between 08.00 and 23.00 on any day on premises authorised to sell alcohol for consumption on those premises, provided that the audience does not exceed 500.
 - a performance of amplified live music between 08.00 and 23.00 on any day, in a workplace that is not licensed to sell alcohol on those premises, provided that the audience does not exceed 500.

- a performance of amplified live music between 08.00 and 23.00 on any day, in a church hall, village hall, community hall, or other similar community premises, that is not licensed by a premises licence to sell alcohol, provided that (a) the audience does not exceed 500, and (b) the organiser gets consent for the performance from a person who is responsible for the premises.
- a performance of amplified live music between 08.00 and 23.00 on any day, at the non-residential premises of (i) a local authority, or (ii) a school, or (iii) a hospital, provided that (a) the audience does not exceed 500, and (b) the organiser gets consent for the performance on the relevant premises from: (i) the local authority concerned, or (ii) the school or (iii) the health care provider for the hospital.
- **Recorded Music:** no licence permission is required for:
 - any playing of recorded music between 08.00 and 23.00 on any day on premises authorised to sell alcohol for consumption on those premises, provided that the audience does not exceed 500.
 - any playing of recorded music between 08.00 and 23.00 on any day, in a church hall, village hall, community hall, or other similar community premises, that is not licensed by a premises licence to sell alcohol, provided that (a) the audience does not exceed 500, and (b) the organiser gets consent for the performance from a person who is responsible for the premises.
 - any playing of recorded music between 08.00 and 23.00 on any day, at the non-residential premises of (i) a local authority, or (ii) a school, or (iii) a hospital, provided that (a) the audience does not exceed 500, and (b) the organiser gets consent for the performance on the relevant premises from: (i) the local authority concerned, or (ii) the school proprietor or (iii) the health care provider for the hospital.
- **Dance:** no licence is required for performances between 08.00 and 23.00 on any day, provided that the audience does not exceed 500. However, a performance which amounts to adult entertainment remains licensable.
- **Cross activity exemptions:** no licence is required between 08.00 and 23.00 on any day, with no limit on audience size for:
 - any entertainment taking place on the premises of the local authority where the entertainment is provided by or on behalf of the local authority;
 - any entertainment taking place on the hospital premises of the health care provider where the entertainment is provided by or on behalf of the health care provider;
 - any entertainment taking place on the premises of the school where the entertainment is provided by or on behalf of the school proprietor; and
- any entertainment (excluding films and a boxing or wrestling entertainment) taking place at a travelling circus, provided that (a) it takes place within a moveable structure that accommodates the audience, and (b) that the travelling circus has not been located on the same site for more than 28 consecutive days.

6. **Further information:** You should use this box to provide any additional evidence to support your claim that the proposed variation is 'minor' and could not have an adverse impact on the promotion of the licensing objectives

7. **Signatures:** The application form must be signed.

8. **Authorised agent:** An applicant's agent (e.g. solicitor) may sign the form on their behalf and, in so doing, will be confirming that they have actual authority to do so.

9. **2nd Applicant:** Where there is more than one applicant, both applicants or their respective agents must sign the application form.

10. This is the address which we shall use to correspond with you about this application. This might not be the same as the address of the premises or applicant, but these addresses must also be provided.

NOTES:
Red outline indicates areas for all licensable activities

This drawing, design & all information contained herein remains the sole copyright of CONCORDE BGW & reproduction in any form is strictly forbidden unless permission is obtained in writing.
 NOTES:
 - Do not scale from this drawing, all dimensions must be checked on site. The contractor must verify all site dimensions, drawings, details & specifications. Any discrepancies must be reported to CONCORDE BGW prior to any commencement of work.
 - Figured dimensions to take preference over those scaled.
 - All specified items are to be installed in accordance with the manufacturers recommendations & instructions.
 © Copyright

DISCLAIMER
 A full and accurate measured survey has not been undertaken by Concorde BGW at this site. This drawing has been produced from information provided by others. Any dimensions indicated are for information only and must be checked on site prior to the commencement of any works

- Fire symbols for new installations:**
 Existing to be re-used where installation deemed satisfactory for re-use as advised by appointed sub contractor. New installations to be installed as required and connected in to existing fire alarm system
- Alarm Call Point
 - Smoke Detector
 - Heat Detector
 - Fire Blanket
 - Alarm Sounder
 - Alarm sounder with flasher unit
 - Fire Action Notice
 - "Fire door Keep closed" signage
 - "Fire door Keep locked" signage
 - "Push Bar to open" and "Fire Door Keep Clear" signage
 - "Fire Door Keep Clear" signage
 - 30 min fire door with smoke seals
 - 60 min fire door with smoke seals
 - Fire alarm control panel
 - Self closing device
 - Vision Panel
 - Push Bar ironmongery
 - 3hour self contained non-maintained luminaire
 - 3 hour self contained and maintained luminaire with arrow where necessary
 - 3 hour self contained and maintained external luminaire
 - Carbon Dioxide extinguisher
 - Water extinguisher
 - Dry Powder extinguisher
 - Foam extinguisher
 - Wet Chemical extinguisher

C	05.08.21	ND	KEY MOVED SO KITCHEN IS VISIBLE
B	28.07.21	ND	DINING ROOM ENTRANCE ADJUSTED TO SUIT SITE DIMS.
A	21.07.21	ND	STAGE UPDATED FOR CONSTRUCTION

Rev: Date: Init: Note: © Copyright

Stage: **CONSTRUCTION**

Client: **LONGBOW BARS & RESTAURANTS**

Project address:
**THE GEORGE HOTEL
 MAIN ROAD
 HATHERSAGE
 HOPE VALLEY
 S32 1BB**

Title: **PROPOSED LICENSING PLAN - GROUND FLOOR**

Scale: 1:50 Dwg size: A1

Drawn by: ND Date: JULY 21

Drawing no: 4558-07-01 Rev: C

**CONCORDE
 BGW GROUP**

London Thomas Ford House 23-24 Smithfield St EC1A 9LF
 Doncaster Palmer Street Hyde Park Business Centre Doncaster DN4 5DD
 Nottingham Unit 3, The Glade Business Centre Forum Road Nottingham NG5 9RW

01302 361 024 concordebgw.com

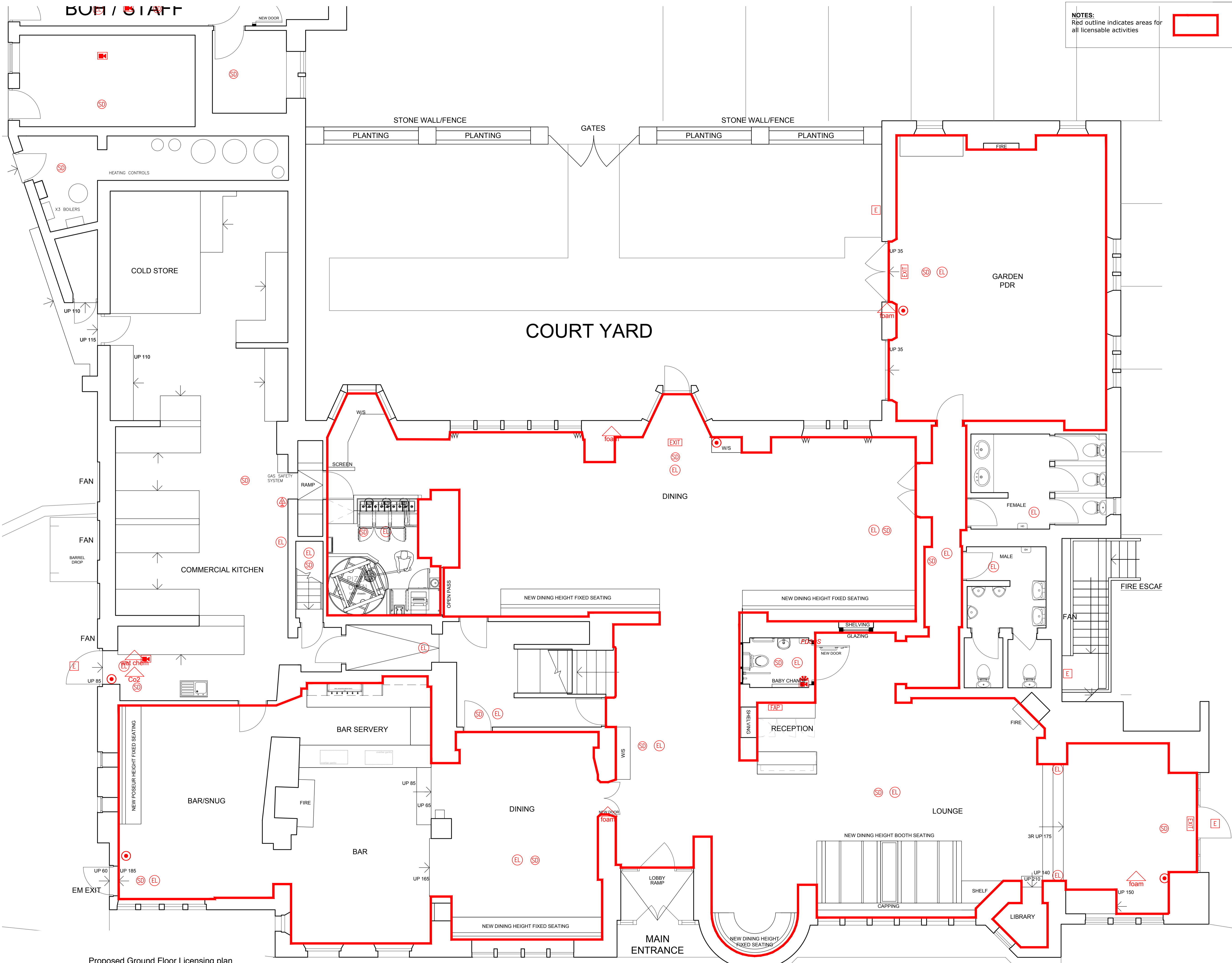

Proposed Ground Floor Licensing plan
 Scale 1:50

0 1 2 3 4 5 6
 metres (for 1:50 original)